

# BEYOND THE LINE

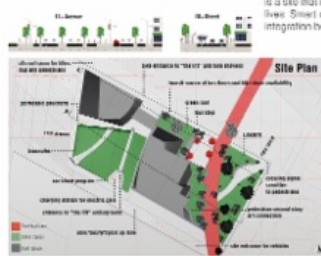

Smart city **Community** is a site that brings together members of the Chicanos neighborhood, residents from all income levels, and tourists. Smart city **Access** is a site that provides equal access to all residents no matter their identity, orientation, or ability. Smart city **Technology** is a site that integrates modern tech to help residents live more efficient lives. Smart city **Synergy** provides two stories of public realm for true integration between private and public design.

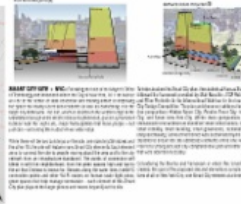

## LEED for New Construction (v4)

- 100% Recycled Content
- 100% Recycled Content
- 100% Recycled Content
- 100% Recycled Content
- 100% Recycled Content
- 100% Recycled Content
- 100% Recycled Content
- 100% Recycled Content
- 100% Recycled Content
- 100% Recycled Content

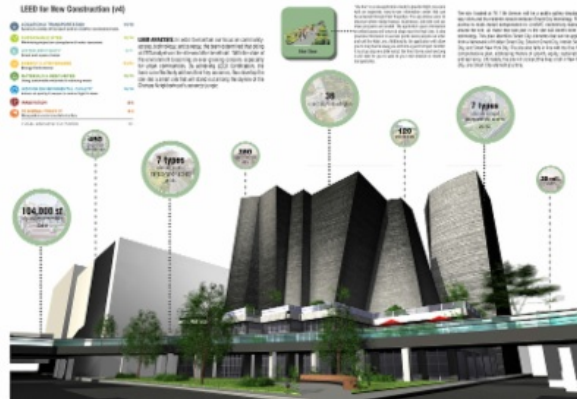

The SMART Cats team is in the finals for the APA Smart Cities Student Design Competition!

## Landscape Architecture and Regional & Community Planning Monday Memo 03.27.17

### ANNOUNCEMENTS

**Jon Champlain, MLA '10, Senior Associate at EDSA NYC, will make a presentation** about his firm and their work on Wednesday, March 29, 4:30 pm, LARCP corner at APDWest. Don't miss this opportunity to hear about EDSA's work. The presentation will be followed by pizza/sandwiches provided by EDSA.

**LARCP and APDesign will hold** an alumni reception during the APA meeting in New York City. The event, hosted by Pier55 at the IAC Building, will be Monday, May 8, 6:30 - 8:30 pm. Please be sure that Jody has your name on the list of attendees if you will be in NYC. Space is limited and we don't want to miss anyone.

### OUR CONTRIBUTIONS AND ACCOMPLISHMENTS

**The SMART Cats Team is one of five finalists** in the [APA Smart Cities Student Competition](#). The interdisciplinary team applied place-based Smart City technologies to a specific site in New York City. They will present their ideas at the 2017 National Planning Conference in May. Members of the team are MRCP students Amber Berg, Rial Carver, Samantha Estabrook, Rachel Foss, Lesley Frohberg, Chris Kutz, Annapurna Singh, Regan Tokos, Mel Wilson and 2nd yr architecture student Jake Frazier with assistance from MLA student Tim Kellams. Professors Belanger and Gibson provided review.

**Assistant Professor Alpa Nawre co-presented** a paper, *Addressing climate change with water landscapes in India*, at the American Collegiate Schools of Architecture Annual Conference in Detroit with Carey Clouse, Assistant Professor at UMass, Amherst, on March 24. Alpa also attended the JAE editorial Board meetings March 24-25.

### STUDO AND CLASS ACTIVITIES

**The LARCP Field Trips were pretty spectacular!**  
Click on the images below to see some of places they went and the things they saw.

### EVENTS & DEADLINES

[2017 LARCP Calendar of Events](#), v011617

#### MARCH

27 Jarvis intent to apply due, 5:00 pm

30 LARCP Faculty Meeting, 12:30 - 1:30 pm, Chang Gallery, [agenda](#), [related files](#)

#### APRIL

1 Open House

6 LA Faculty Meeting, 12:30 - 1:30 pm, Edmond's Conference Room

7 KC APA 6th Annual Internship Fair, 1:30 - 4:30 pm, UMKC Katz Hall

10 Jarvis proposals due, 5:00 pm

13 RCP Faculty Meeting, 12:30 - 1:30 pm, Chang Gallery

15 Deadline for reporting Fall 2017 course material adoptions. see previous MMs for instructions.

20 LARCP Faculty Meeting, 12:30 - 1:30 pm, Chang Gallery

21 KS APA Spring

**Boston:**



25 Jarvis presentations, 6:00 pm, Wahoo Fire and Ice Grill

27 Green Roof Outreach Event, 6:30 - 8:00 pm, Purple Masque Theater

**CONNECT WITH US**

**BLOGS**

[Creative Placemaking Blog](#)

[The Meadow Blog](#)

[planpop: the City Planning & POP Culture Blog](#)

[Planning & Pop Culture Podcasts 2016](#)

**SOCIAL MEDIA**

[@KStateLARCP](#)

[#LARCP](#)

[LARCP LinkedIn Group](#)

**NEWS AND INFORMATION**

[K-State Website](#)

[LARCP Alumni eNewsletter](#)

[LARCP Page on KReX](#)

[LARCP Scholarship and Fellowship Board](#)

[LARCP Website](#)

[Past LARCP Monday Memos, Student Connections and Alumni Newsletters](#)

[Prairie Studies Initiative](#)

[Weigel Library Website](#)

**Portland:**

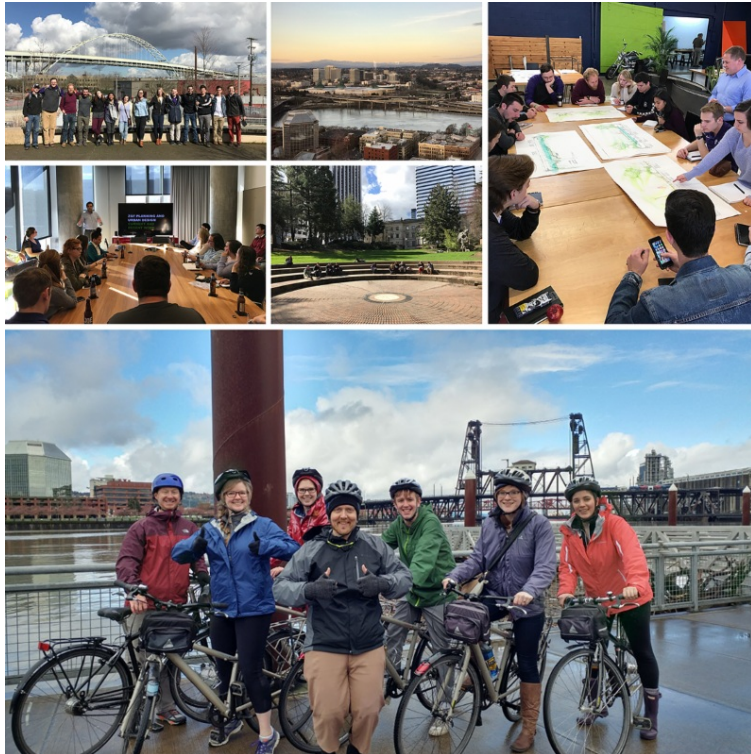

**OF INTEREST**

**Online guide to Italian street types**, [available here](#), shared by Katie Kingery-Page.

**Be among the first to sign** the New Landscape Declaration: <https://lafoundation.org/news-events/2016-summit/new-landscape-declaration/>

**The LA+ Journal invites** speculations on the question of time. Abstracts are due April 1 and [information is available here](#).

**The Biomimicry Institute and the Ray C. Anderson Foundation** have launched the Biomimicry Global Design Challenge, open to both students and professionals worldwide. [Click here](#) for more information. Submissions are due April 30.

**The ACSP 2017 Call for Abstracts** is [available here](#). The theme is Cities, Regions, and Growth: Smart, Inclusive, Equitable?. Abstracts are due April 17.

**ASLA Design Competition Entries** are due April 17 (Professional) and

May 15 (Student). Information is [available here](#).

**The LA+ Journal announces** the launch of an open design ideas competition. Entries close June 2. [Information is available here](#).

**University of Washington Professor Daniel Winterbottom is offering** a landscape architecture design build program in China in collaboration with Guizhou Normal University, June 15 - July 15. Information is available here.

#### **UPCOMING PROFESSIONAL SOCIETY MEETINGS:**

KS APA Spring Symposium	April 21, 2017	Leavenworth County
<a href="#">American 10-13, Planning Association</a>	May 6-9, 2017	New York, New York
KSU Alumni Reception, May 8, 6:30-8:30 pm, IAC Building		
Alliance for Historic Landscape Preservation	May 25-27, 2017	Calgary, Alberta
<a href="#">CELA 2017 conference information, call for abstracts</a>	May 26-29, 2017	Beijing, China
<a href="#">ECLAS 2017</a>	September 10-13, 2017	London, UK
<a href="#">IMCL 2017</a>	October 2-6, 2017	Santa Fe, NM

LARCP Department | (785) 532-5961 | [lrcpdept@ksu.edu](mailto:lrcpdept@ksu.edu) | 302 Seaton Hall  
Kansas State University  
Manhattan, KS 66505