

# BEYOND THE LINE

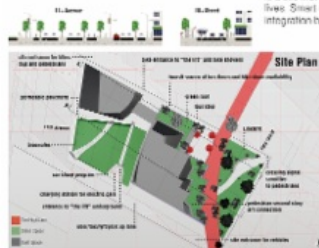

Smart city **Community** is a site that brings together members of the Chelsea neighborhood, residents from all income levels, and tourists. Smart city **Access** is a site that provides equal access to all residents no matter their identity, orientation, or ability. Smart city **Technology** is a site that integrates modern tech to help residents live more efficient lives. Smart city **Synergy** provides two stories of public realm for true integration between private and public design.

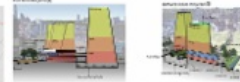

**SMART CITY CATS - NYC** Competition in a competition that... (text is small and partially obscured)

LEED for New Construction (v4)

Category	Points
Location Sensitive Design	4
Water Efficient Use	5
Energy Efficient Use	10
Materials and Resources	11
Indoor Environmental Quality	14
Quality of the Environment	11
Green Building	10
Smart Building	10
Leadership in Energy and Environmental Design	10
<b>Total</b>	<b>85</b>

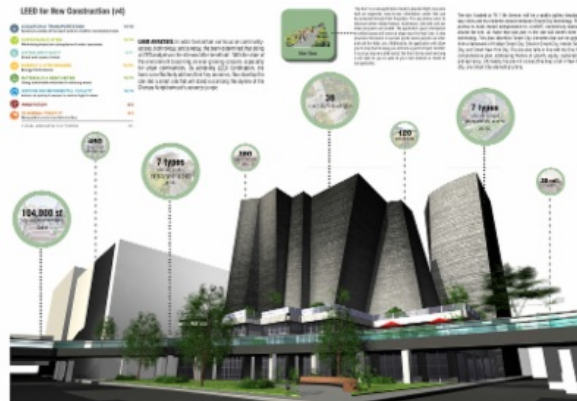

The SMART Cats team is in the finals for the APA Smart Cities Student Design Competition!

## Landscape Architecture and Regional & Community Planning Student Connection 03.28.17

### ANNOUNCEMENTS

**Jon Champlin, MLA '10, Senior Associate at EDSA NYC, will make a presentation** about his firm and their work tomorrow, March 29, 4:30 pm, LARCP corner at APDWest. Don't miss this opportunity to hear about EDSA's work. The presentation will be followed by pizza provided by EDSA.

**The PGASLA Awards Entries are due this Friday, March 31.** Information is [available here](#). The Awards Gala will take place on May 6th at the Center for Architecture and Design in Kansas City.

### OUR CONTRIBUTIONS AND ACCOMPLISHMENTS

**Caroline Finck, MLA 4th year, is the recipient** of the 2017 MESA Design Discovery Award. MESA makes a \$2,500 award allowing them to explore, learn, and broaden their design awareness while studying a specific topic. The award will support Caroline's master's thesis research focused on design of an integrated rural community that fosters acceptance and understanding of developmentally disabled population. She will travel to Geel, Belgium; Gould Farm in Monterey, MA; Broadway Communities in New York City; and, Spirit of Geel outside of Philadelphia.

**The SMART Cats Team is one of five finalists** in the [APA Smart Cities Student Competition](#). The interdisciplinary team applied place-based Smart City technologies to a specific site in New York City. They will present their ideas at the 2017 National Planning Conference in May. Members of the team are MRCP students Amber Berg, Rial Carver, Samantha Estabrook, Rachel Foss, Lesley Froberg, Chris Kutz, Annapurna Singh, Regan Tokos, Mel Wilson and 2nd yr architecture student Jake Frazier with assistance from MLA student Tim Kellams. Professors Belanger and Gibson provided review.

**MLA students will present** posters at the K-State Graduate School Research Forum on March 30. Their posters will be on display 9:30 am - 4:30 pm in the K-State Union Courtyard:

### EVENTS & DEADLINES

[2017 LARCP Calendar of Events](#), v011617

#### MARCH

31 PGASLA awards entries due, [information here](#)

#### APRIL

1 Open House

7 KC APA 6th Annual Internship Fair, UMKC Pierson Auditorium, 1-4 pm

21 KS APA Spring Symposium

27 Green Roof Outreach Event, 6:30-8:00 pm, Purple Masque Theater

#### MAY

5 Classes end

6 PGSALA Awards Gala, Center for Architecture and Design, Kansas City

6-9 APA Conference, New York

13 Commencement

26-29 CELA, Beijing, China

- Abigail Fiala will present *Nature through nature: a comparative study between standard and nature-based play in outdoor preschool environments*.
- Timothy Kellams will present *The mind, the narrative, and the city: drawing narratives of the city*.

**Assistant Professor Alpa Nawre co-presented** a paper, *Addressing climate change with water landscapes in India*, at the American Collegiate Schools of Architecture Annual Conference in Detroit with Carey Clouse, Assistant Professor at UMass, Amherst, on March 24. Alpa also attended the JAE Editorial Board meetings March 24-25.

## INTERNSHIP/EMPLOYMENT OPPORTUNITIES

**MTA New York City Transit**, Summer Internship, [Information](#), deadline April 3

**City of Dallas: Planning + Design**, Entry-level Position, [Information](#), deadline April 22

**Carbon Lighthouse**, Multiple Positions, [Information](#)

**LAAB**, Summer Internship, [Information](#), deadline March 31

**ASLA**, Summer Communications Internship, [Information](#), deadline March 31

**American Association of State Highway and Transportation Officials**, Program Specialist for Policy, [Information](#), deadline April 7

**Gardner + Semler Landscape Architecture Design**, Entry-level Position and Internship, [Information](#)

**American Public Transportation Association**, Policy Analyst, [Information](#)

**Nelson/Nygaard**, Internships, [Information](#)

**City of Clive**, Planner/GIS Specialist, [Information](#), deadline April 14

**IMG Rebel**, Summer Internship, [Information](#)

**IMG Rebel**, Consultant/Senior Consultant, [Information](#)

**Meier Consulting LLC**, Summer Internship, [Information](#)

## STUDIO AND CLASS ACTIVITIES

**The LARCP Field Trips were pretty spectacular!**

Click on the images below to see some of the places they went and the things they saw.

Boston:



Portland:

## CONNECT WITH US

### BLOGS

[Creative Placemaking Blog](#)

[The Meadow Blog](#)

[planpop: the City Planning & POP Culture Blog](#)

[Planning & Pop Culture Podcasts 2016](#)

### SOCIAL MEDIA

[@KStateLARCP](#)  
[#LARCP](#)

[LARCP LinkedIn Group](#)

### NEWS AND INFORMATION

[K-State Website](#)

[LARCP Alumni eNewsletter](#)

[LARCP Page on KReX](#)

[LARCP Scholarship and Fellowship Board](#)

[LARCP Website](#)

[Past LARCP Monday Memos, Student](#)

[Connections and Alumni Newsletters](#)

[Prairie Studies Initiative](#)

[Weigel Library Website](#)



## OF INTEREST

**Be among the first to sign the New Landscape Declaration:**  
<https://lafoundation.org/news-events/2016-summit/new-landscape-declaration/>

### CDPLN701: International Development

**Online guide to Italian street types**, [available here](#), shared by Katie Kingery-Page.

**ASLA Design Competition Entries** are due April 17 (Professional) and May 15 (Student). Information is [available here](#).

**The Biomimicry Institute and the Ray C. Anderson Foundation have launched** the Biomimicry Global Design Challenge, open to both students and professionals worldwide. [Click here](#) for more information. Submission are due April 30.

**The LA+ Journal invites** speculations on the question of time. Abstracts are due April 1 and [information is available here](#).

**The LA+ Journal announces** the launch of an open design ideas competition. Entries close June 2. [Information is available here](#).

**University of Washington Professor Daniel Winterbottom is offering** a landscape architecture design build program in China in collaboration with Guizhou Normal University, June 15 - July 15. [Information is available here](#).

The Vectorworks Scholarship program offers two generous scholarships. Entries are due July 15. Information is [available here](#).

### UPCOMING PROFESSIONAL SOCIETY MEETINGS:

<b>American Planning Association</b>	May 6-9, 2017	New York, New York
<b>Alliance for Historic Landscape Preservation</b>	May 25-27, 2017	Calgary, Alberta
<b>CELA 2017</b>	May 26-29, 2017	Beijing, China
<b>ECLAS 2017</b>	September 10-13, 2017	London, UK

LARCP Department | (785) 532-5961 | [lrcpdept@ksu.edu](mailto:lrcpdept@ksu.edu) | 302 Seaton Hall  
Kansas State University  
Manhattan, KS 66505